

Step Accuracy-----±5%
 Temperature Rise-----80℃ Max.
 Ambient Temperature Range-----20℃~+50℃
 Insulation Resistance-----100MΩ Min.50V DC
 Dielectric Strength-----500V AC 1minute

电机型号 Model	步距角 Step angle (°)	机身長 Motor Length L (mm)	相电压 Rate Voltage (V)	相电流 Rate Current (A)	相电阻 Phase Resistance (Ω)	相电感 Phase Inductance (mH)	静力矩 Holding Torque (N.m)	引线数 Lead Wire (NO.)	转动惯量 Rotor Inertia (kg.cm ²)	定位力矩 Detent Torque (kg.cm)	重量 Motor Weight (kg)
86BYGH450B-001	1.8	97	6.27	1.65	3.8	24	5.2	4	2.2	2	2.9
86BYGH450B-002	1.8	97	3.9	3	1.3	7.5	5.1	4	2.2	2	2.9
86BYGH450B-003	1.8	97	3.2	4	0.8	5.2	5.4	4	2.2	2	2.9

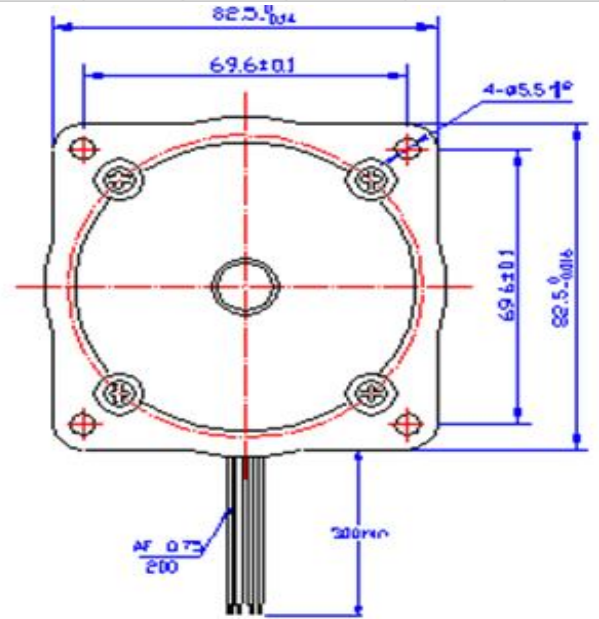

Wiring Diagram (接线图)

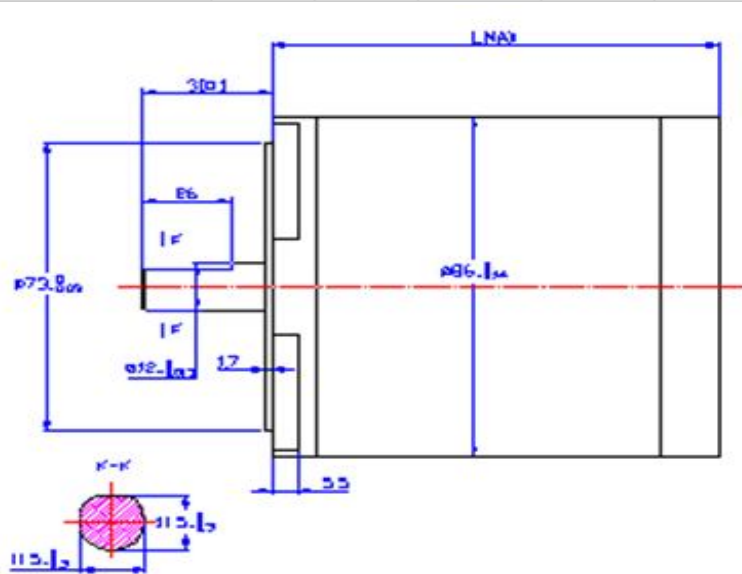